

Product Image

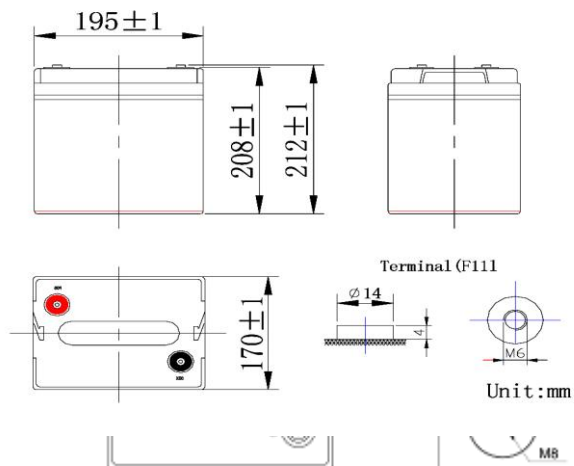

Product Dimensions



Characteristics

Nominal Voltage		12V
Nominal Capacity (10 hour rate)		120Ah
Capacity 25°C (77 F)	20 hour rate (6.66A)	133.2Ah
	5 hour rate (21.96A)	109.8Ah
	1 hour rate (79.8A)	79.8Ah
Internal Resistance	Full Charged Battery 25°C	≤5.0mΩ
Capacity affected by Temperature (10 hour)	40°C (104 F)	102%
	25°C (77 F)	100%
	0°C (32 F)	85%
	-15°C (5 F)	65%
Self-Discharge 25°C (77 F) Capacity	after 3 month storage	90%
	after 6 month storage	80%
	after 12 month storage	62%
Charge (Constant Voltage) 25°C (77 F)	Float	Initial Charging Current Less than 75.6A Voltage 6.8-6.9V
	Cycle	Initial Charging Current Less than 75.6A Voltage 7.2-7.45V

Packaging

Battery Dimensions	Length	195mm
	Width	170mm
	Height	206mm
	Total Height	112mm
Box Dimensions	Length	210mm
	Width	184mm
	Height	256mm
Quantity Per Box		1 PC per box
Net weight Per Cell		16.5kg±200g
Net weight Per Box		16.5kg
Gross Weight		17.0kg

恒电流放电参数表 (25° C)

终止电压/单格	5min	10min	15min	30min	45min	1h	2h	3h	5h	8h	10h	20h
1. 60V	499.0	318.1	270.3	172.6	126.8	116.4	53.2	52.0	35.3	23.3	20.8	11.5
1. 65V	489.9	312.3	265.4	169.4	124.5	114.3	52.3	51.0	34.7	22.9	20.4	11.3
1. 70V	480.8	306.5	260.4	166.3	122.2	112.2	51.3	50.1	34.1	22.4	20.0	11.1
1. 75V	471.7	300.7	255.5	163.1	119.9	110.1	50.3	49.1	33.4	22.0	19.7	10.9
1. 80V	453.6	289.2	245.7	156.9	115.3	105.8	48.4	47.3	32.1	21.2	18.9	10.50

恒功率放电参数表 (25° C)

终止电压/单格	5min	10min	15min	30min	45min	1h	2h	3h	5h	8h	10h	20h
1. 60V	960.5	612.3	520.3	332.2	244.1	224.1	102.5	100.1	68.0	44.8	40.0	22.2
1. 65V	943.0	601.2	510.8	326.1	239.7	220.0	100.6	98.2	66.8	44.0	39.3	21.8
1. 70V	925.6	590.1	501.4	320.1	235.2	216.0	98.7	96.4	65.6	43.2	38.6	21.4
1. 75V	908.1	578.9	491.9	314.1	230.8	211.9	96.9	94.6	64.3	42.4	37.8	21.0
1. 80V	873.2	556.7	473.0	302.0	221.9	203.7	93.1	91.0	61.9	40.7	36.4	20.2

注：以上数据是三次充放电循环的平均值，不是最小值。以上信息如有改动，恕不另行通知，请联系中商国通获取最新资讯

Performance Characteristics

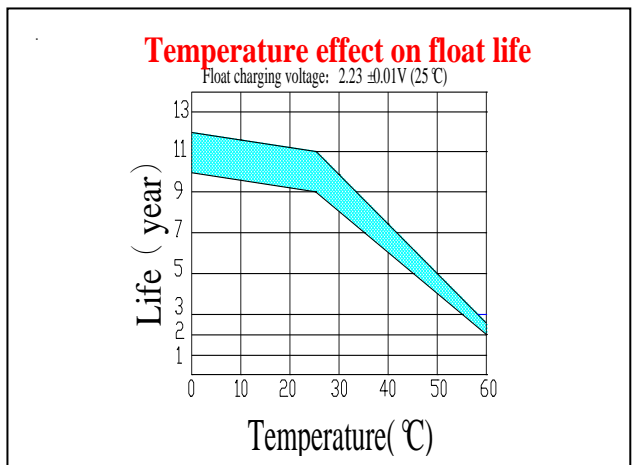
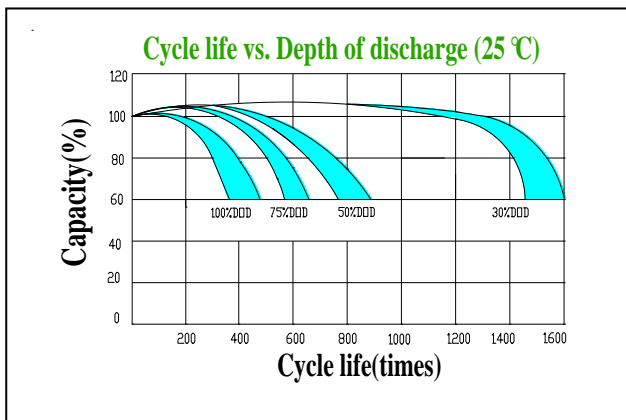
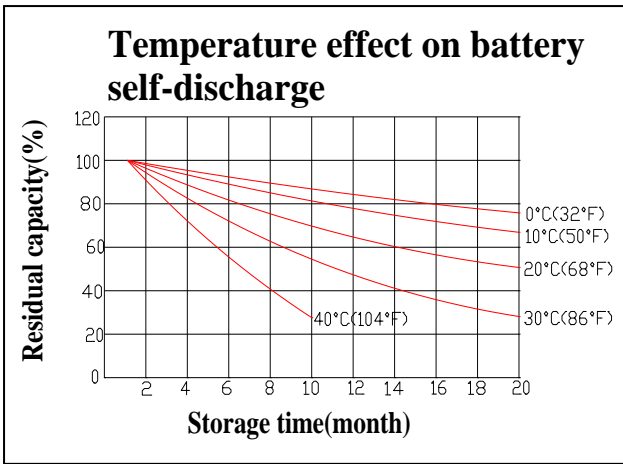
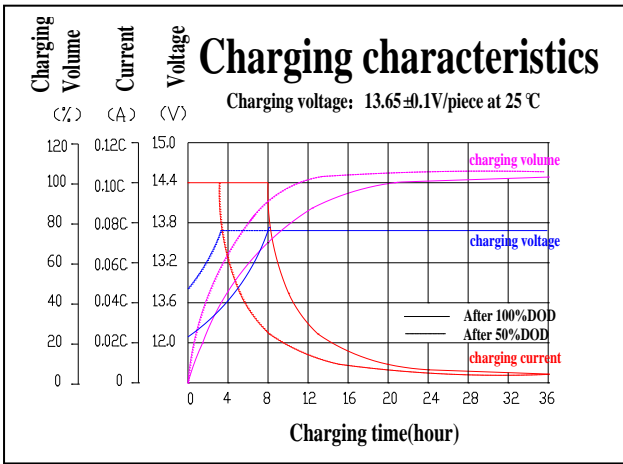

Battery Construction

Component	Positive plate	Negative plate	Container	Cover	Safety valve	Terminal	Separator	Electrolyte
Raw material	Lead dioxide	Lead	ABS	ABS	Si-Rubber	Lead	Fiberglass	Colloid(GEL)

Guangzhou Hengda Battery Co.,Ltd
 Tel: 020-84866132 02084866098 Fax: 020-84869892
 021-52811136; 021-52826931; 021-52826931-19

JAPATOYO®
<http://www.japatoyo.com>