

Product Image

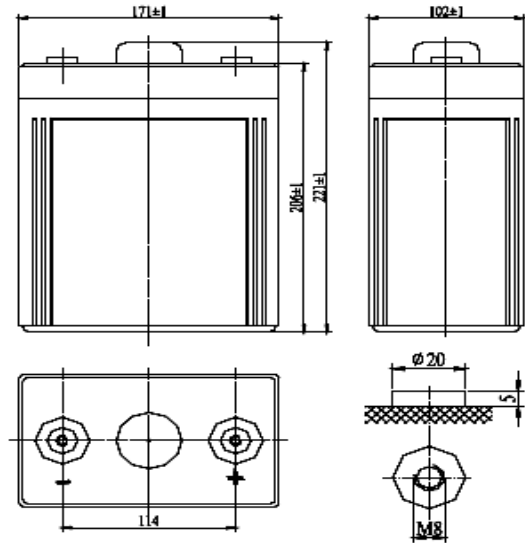

Product Dimensions



Characteristics

| | | |
|--|---------------------------|--|
| Nominal Voltage | | 2V |
| Nominal Capacity (10 hour rate) | | 150Ah |
| Capacity 25°C (77 °F) | 20 hour rate (7.95A) | 159Ah |
| | 5 hour rate (26.5A) | 132.5Ah |
| | 1 hour rate (82.5A) | 82.5Ah |
| Internal Resistance | Full Charged Battery 25°C | ≤1.5mΩ |
| Capacity affected by Temperature (10 hour) | 40°C (104 °F) | 102% |
| | 25°C (77 °F) | 100% |
| | 0°C (32 °F) | 85% |
| | -15°C (5 °F) | 65% |
| Self-Discharge 25°C (77 °F) Capacity | after 3 month storage | 90% |
| | after 6 month storage | 80% |
| | after 12 month storage | 62% |
| Charge (Constant Voltage) 25°C (77 °F) | Float | Initial Charging Current Less than 22.5A Voltage 2.24-2.28V |
| | Cycle | Initial Charging Current Less than 22.5A Voltage 2.33-2.37V |

Packaging

| | | |
|-----------------------|-----------------|--------------|
| Battery Dimensions | Length | 171mm |
| | Width | 72mm |
| | Height | 206mm |
| | Total Height | 226mm |
| Box Dimensions | Length | 224mm |
| | Width | 187mm |
| | Height | 261mm |
| Quantity Per Box | | 2 PC per box |
| Net weight Per Cell | | 6.0 kg ±200g |
| Net weight Per Box | | 12.0kg |
| Gross Weight | | 12.5kg |

Discharge Constant Current per Cell (Amperes at 77°F/25°C)

| F.V/Time | 5min | 10min | 15min | 30min | 45min | 1h | 2h | 3h | 5h | 8h | 10h | 20h |
|----------|------|-------|-------|-------|-------|----|----|----|----|----|------|-----|
| 1.60V | 419 | 271 | 224 | 149 | 111 | 91 | 58 | 41 | 28 | 18 | 16.5 | 8.7 |
| 1.65V | 411 | 266 | 220 | 146 | 109 | 89 | 57 | 41 | 28 | 18 | 16.2 | 8.6 |
| 1.70V | 404 | 261 | 216 | 143 | 107 | 87 | 56 | 40 | 27 | 18 | 15.9 | 8.4 |
| 1.75V | 396 | 256 | 212 | 140 | 105 | 86 | 55 | 39 | 27 | 17 | 15.6 | 8.3 |
| 1.80V | 381 | 246 | 204 | 135 | 101 | 83 | 53 | 38 | 26 | 17 | 15.0 | 8.0 |

Discharge Constant Power per Cell (Watts at 77°F 25°C)

| F.V/Time | 5min | 10min | 15min | 30min | 45min | 1h | 2h | 3h | 5h | 8h | 10h | 20h |
|----------|------|-------|-------|-------|-------|-----|-----|----|----|----|------|------|
| 1.60V | 807 | 521 | 432 | 286 | 213 | 175 | 111 | 79 | 54 | 36 | 31.8 | 16.8 |
| 1.65V | 792 | 511 | 424 | 281 | 209 | 172 | 109 | 78 | 53 | 35 | 31.2 | 16.5 |
| 1.70V | 777 | 502 | 416 | 275 | 205 | 168 | 107 | 77 | 52 | 34 | 30.6 | 16.2 |
| 1.75V | 763 | 492 | 408 | 270 | 201 | 165 | 105 | 75 | 51 | 34 | 30.0 | 15.9 |
| 1.80V | 733 | 474 | 393 | 260 | 193 | 159 | 101 | 72 | 49 | 32 | 28.9 | 15.3 |

Note The above data are average values, and can be obtained within 3 charge/discharge cycles. These are not minimum values. Cell and battery designs/specifications are subject to modification without notice. Contact **US** for the latest information.

Performance Characteristics

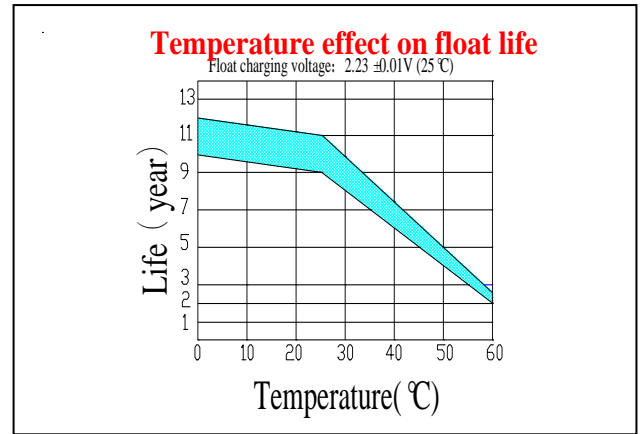
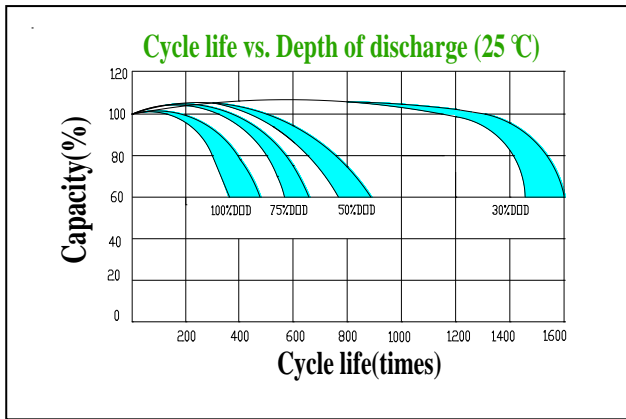
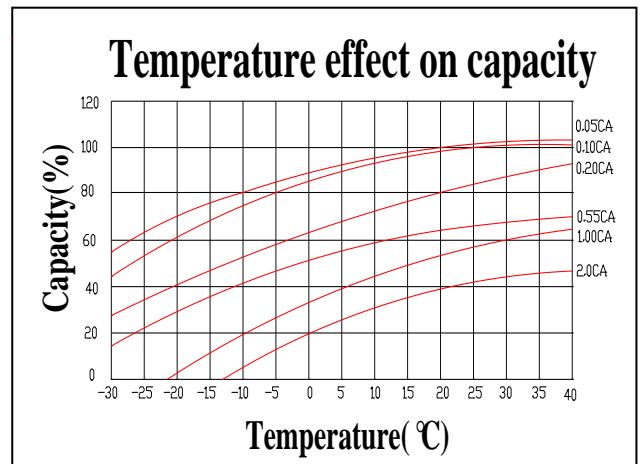
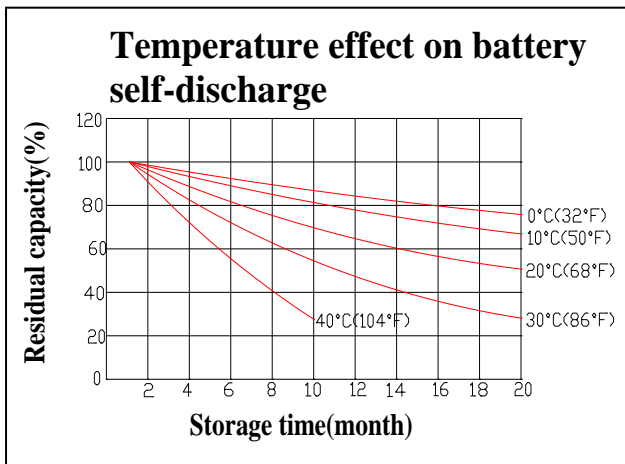
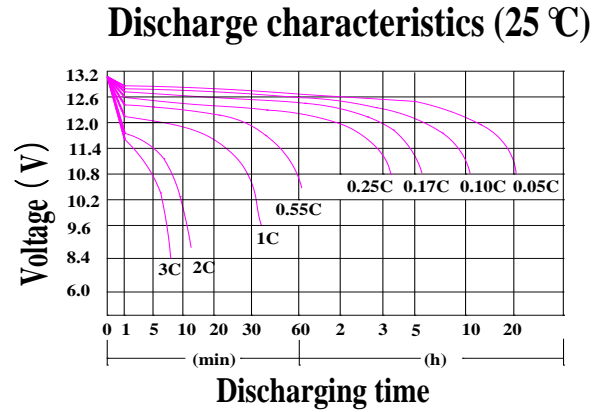
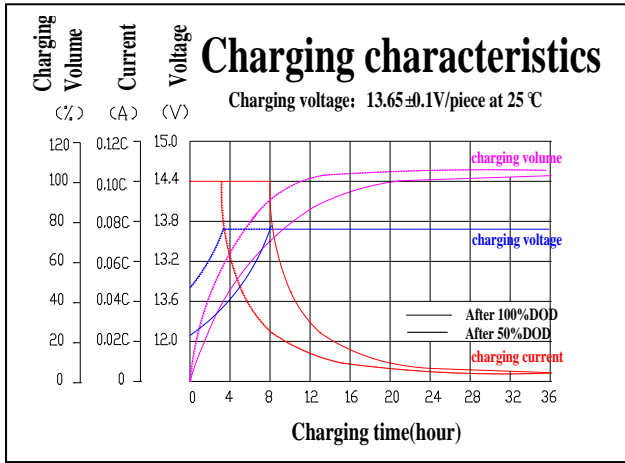

Battery Construction

| Component | Positive plate | Negative plate | Container | Cover | Safety valve | Terminal | Separator | Electrolyte |
|--------------|----------------|----------------|-----------|-------|--------------|----------|------------|--------------|
| Raw material | Lead dioxide | Lead | ABS | ABS | Si-Rubber | Lead | Fiberglass | Colloid(GEL) |

Guangzhou Hengda Battery Co.,Ltd

Tel: 020-84866132 02084866098 Fax: 020-84869892
021-52811136; 021-52826931; 021-52826931-19